

KABLOVSKЕ PАРУЋИCE ZА GNJEЋENJE GP
CABLE CRIMPING TERMINALS GP
КАБЕЛЬНЫЕ НАКОНЕЧНИКИ GP

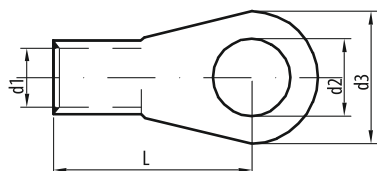

MATERIJAL: Cu
STANDARD: DIN 46234
MATERIAL: Cu
STANDARD: DIN 46234
МАТЕРИАЛ: Cu
СТАНДАРТ: DIN 46234



R.broj Nr п/п	Presek provodnika Cable intersection Сечение	Kodni broj Code Код (номер)	Tip Type Тип	Dimenzije (mm) Dimension (mm) Размер (мм)				Pakovanje Packing Упаковка	Masa Weight Вес
				d1	d2	d3	L		
1	0.75 - 1	D40-05-04	GP 1/4	1.6	4.3	8.0	12.0	200	0.152
2	0.75 - 1	D40-05-05	GP 1/5	1.6	5.3	10.0	13.0	200	0.176
3	0.75 - 1	D40-05-81	GP 1/6	1.6	6.5	11	14.0	200	0.179
4	1.5	D40-05-06	GP 1.5/3	2.3	3.2	6.0	11.0	200	0.110
5	1.5	D40-05-07	GP 1.5/4	2.3	4.3	8.0	12.0	200	0.136
6	1.5	D40-05-08	GP 1.5/5	2.3	5.3	10.0	14.0	200	0.170
7	1.5	D40-05-09	GP 1.5/6	2.3	6.5	11.0	16.0	200	0.172
8	1.5	D40-05-10	GP 1.5/8	2.3	8.4	14.0	17.0	200	0.166
9	2.5	D40-05-11	GP 2.5/3	2.3	3.2	6.0	11.0	200	0.132
10	2.5	D40-05-12	GP 2.5/4	2.3	4.3	8.0	12.0	200	0.156
11	2.5	D40-05-13	GP 2.5/5	2.3	5.3	10.0	14.0	200	0.194
12	2.5	D40-05-14	GP 2.5/6	2.3	6.5	11.0	16.0	200	0.216
13	2.5	D40-05-15	GP 2.5/8	2.3	8.4	14.0	17.0	200	0.200
14	2.5	D40-05-86	GP 2.5/10	2.3	10.5	18.0	19.0	200	0.200
15	4	D40-05-16	GP 4/4	3.6	4.3	8.0	14.0	200	0.198
16	4	D40-05-17	GP 4/5	3.6	5.3	10.0	15.0	200	0.236
17	4	D40-05-18	GP 4/6	3.6	6.5	11.0	16.0	200	0.242
18	4	D40-05-19	GP 4/8	3.6	8.4	14.0	19.0	200	0.314
19	4	D40-05-20	GP 4/10	3.6	10.5	18.0	21.0	200	0.330
20	6	D40-05-21	GP 6/4	3.6	4.3	8.0	14.0	200	0.288
21	6	D40-05-22	GP 6/5	3.6	5.3	10.0	15.0	200	0.320
22	6	D40-05-23	GP 6/6	3.6	6.5	11.0	16.0	200	0.350
23	6	D40-05-24	GP 6/8	3.6	8.4	14.0	19.0	200	0.440
24	6	D40-05-25	GP 6/10	3.6	10.5	18.0	21.0	200	0.400
25	10	D40-05-26	GP 10/5	4.5	5.3	10.0	16.0	100	0.208
26	10	D40-05-27	GP 10/6	4.5	6.5	11.0	17.0	100	0.224
27	10	D40-05-28	GP 10/8	4.5	8.4	14.0	20.0	100	0.266
28	10	D40-05-29	GP 10/10	4.5	10.5	18.0	21.0	100	0.326
29	10	D40-05-30	GP 10/12	4.5	13.0	22.0	23.0	100	0.392
30	16	D40-05-31	GP 16/5	5.8	5.3	11.0	20.0	100	0.350
31	16	D40-05-32	GP 16/6	5.8	6.5	11.0	20.0	100	0.382
32	16	D40-05-33	GP 16/8	5.8	8.4	14.0	22.0	100	0.434
33	16	D40-05-34	GP 16/10	5.8	10.5	18.0	24.0	100	0.504
34	16	D40-05-35	GP 16/12	5.8	13.0	22.0	26.0	100	0.592
35	25	D40-05-36	GP 25/5	7.5	5.3	12.0	25.0	100	0.704
36	25	D40-05-37	GP 25/6	7.5	6.5	12.0	25.0	100	0.686
37	25	D40-05-38	GP 25/8	7.5	8.4	16.0	25.0	100	0.728
38	25	D40-05-39	GP 25/10	7.5	10.5	18.0	26.0	100	0.786
39	25	D40-05-40	GP 25/12	7.5	13.0	22.0	31.0	100	0.942
40	25	D40-05-91	GP 25/14	7.5	15.0	22.0	31.0	100	1.100
41	25	D40-05-41	GP 25/16	7.5	17.0	28.0	35.0	100	1.176



KABLOVSKЕ PАРУЋИСЕ ЗА GNJEЋENJE GP
CABLE CRIMPING TERMINALS GP
КАБЕЛЬНЫЕ НАКОНЕЧНИКИ GP

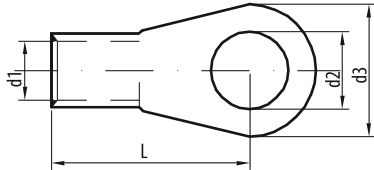

MATERIJAL: Cu
STANDARD: DIN 46234
MATERIAL: Cu
STANDARD: DIN 46234
МАТЕРИАЛ: Cu
СТАНДАРТ: DIN 46234



R.broj Nr. п/п	Presek provodnika Cable intersection Сечение	Kodni broj Code Код (номер)	Tip Type Тип	Dimenzije (mm) Dimension (mm) Размер (мм)				Pakovanje Packing Упаковка	Masa Weight Вес
				d1	d2	d3	L		
42	35	D40-05-42	GP 35/6	9.0	6.5	15.0	26.0	100	0.920
43	35	D40-05-43	GP 35/8	9.0	8.4	16.0	26.0	100	0.908
44	35	D40-05-44	GP 35/10	9.0	10.5	18.0	27.0	100	0.950
45	35	D40-05-45	GP 35/12	9.0	13.0	22.0	31.0	100	1.100
46	35	D40-05-92	GP 35/14	9.0	15.0	22.0	31.0	100	1.200
47	35	D40-05-46	GP 35/16	9.0	17.0	28.0	36.0	100	1.328
48	50	D40-05-79	GP 50/6	11.0	6.5	18.0	34.0	100	1.940
49	50	D40-05-47	GP 50/8	11.0	8.4	18.0	34.0	100	1.896
50	50	D40-05-48	GP 50/10	11.0	10.5	18.0	34.0	100	1.784
51	50	D40-05-49	GP 50/12	11.0	13.0	22.0	36.0	100	1.926
52	50	D40-05-87	GP 50/17	11.0	15.0	22.0	36.0	100	2.150
53	50	D40-05-50	GP 50/16	11.0	17.0	28.0	40.0	100	2.250
54	70	D40-05-74	GP 70/6	13.0	6.5	22.0	38.0	100	2.440
55	70	D40-05-75	GP 70/8	13.0	8.4	22.0	38.0	100	2.386
56	70	D40-05-51	GP 70/10	13.0	10.5	22.0	38.0	100	2.440
57	70	D40-05-52	GP 70/12	13.0	13.0	22.0	38.0	100	2.428
58	70	D40-05-88	GP 70/14	13.0	15.0	22.0	38.0	100	2.550
59	70	D40-05-53	GP 70/16	13.0	17.0	28.0	42.0	100	2.712
60	70	D40-05-84	GP 70/20	13.0	21.0			100	2.600
61	95	D40-05-76	GP 95/8	15.0	8.4	24.0	42.0	50	2.040
62	95	D40-05-54	GP 95/10	15.0	10.5	24.0	42.0	50	2.020
63	95	D40-05-55	GP 95/12	15.0	13.0	24.0	42.0	50	1.962
64	95	D40-05-89	GP 95/14	15.0	15.0	24.0	42.0	50	1.970
65	95	D40-05-56	GP 95/16	15.0	17.0	28.0	44.0	50	1.980
66	95	D40-05-83	GP 95/20	15.0	21.0			50	1.900
67	120	D40-05-77	GP 120/8	16.5	8.4	24.0	44.0	50	2.880
68	120	D40-05-57	GP 120/10	16.5	10.5	24.0	44.0	50	2.800
69	120	D40-05-58	GP 120/12	16.5	13.0	24.0	44.0	50	2.756
70	120	D40-05-85	GP 120/14	16.5	15.0	24.0	44.0	50	2.800
71	120	D40-05-59	GP 120/16	16.5	17.0	28.0	48.0	50	2.938
72	120	D40-05-93	GP 120/20	16.5	21.0			50	2.900
73	150	D40-05-80	GP 150/8	19.0	8.4	30.0	50.0	25	1.920
74	150	D40-05-78	GP 150/10	19.0	10.5	30.0	50.0	25	1.880
75	150	D40-05-60	GP 150/12	19.0	13.0	30.0	50.0	25	1.828
76	150	D40-05-82	GP 150/14	19.0	15.0	30.0	50.0	25	1.800
77	150	D40-05-61	GP 150/16	19.0	17.0	30.0	50.0	25	1.780
78	185	D40-05-70	GP 185/10	21.0	10.5	36.0	50.0	25	2.284
79	185	D40-05-71	GP 185/12	21.0	13.0	36.0	50.0	25	2.250
80	185	D40-05-64	GP 185/14	21.0	15.0	36.0	50.0	25	2.200
81	185	D40-05-62	GP 185/16	21.0	17.0	36.0	50.0	25	2.186
82	240	D40-05-72	GP 240/10	23.5	10.5	38.0	56.0	25	3.670
83	240	D40-05-73	GP 240/12	23.5	13.0	38.0	56.0	25	3.600
84	240	D40-05-90	GP 240/14	23.5	15.0	38.0	56.0	25	3.600
85	240	D40-05-63	GP 240/16	23.5	17.0	38.0	56.0	25	3.582